

****IMPORTANT PLEASE READ****

This is a notice of a running change to the Swing Hangers and some screws included in the following playsets:
Jamboree, Playful Palace, Scrambler

Swing Hanger running change:

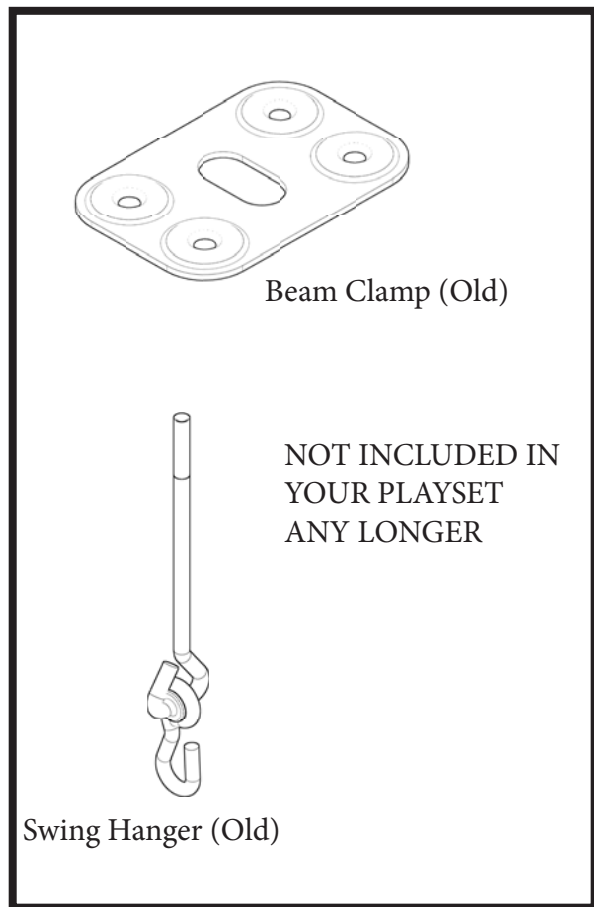

Replaced by

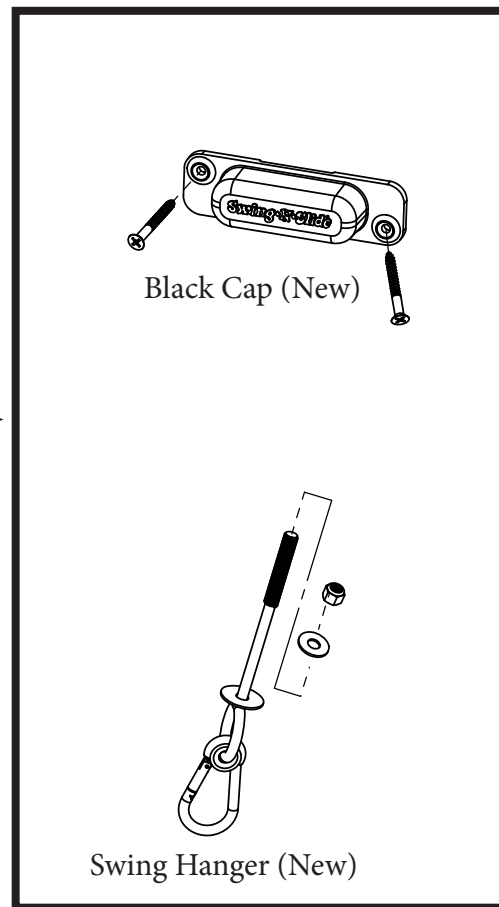

GO TO NEXT PAGE

Swing Hanger Bolt must protrude at least
TWO Threads beyond Lock Nut.



IMPORTANT!

2 Threads MIN.

Use a socket
wrench to tighten
Lock Nut securely
against washer.

Lock Nut

1-3/8" Washer

#6 X 1-1/4" WOOD SCREW X 12

PF 1574 X 6

CAP

3/8" LOCK NUT X 6

1-3/8" FLAT WASHER X 6

3/8" FLAT WASHER X 6

SWING HANGER

 HOLD POSITION OF
SWING HANGER WHILE
TIGHTENING LOCK NUT.

SWING BEAM

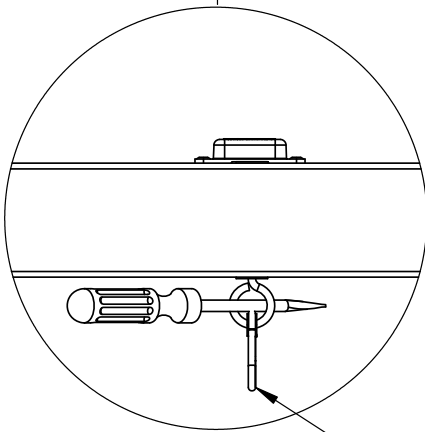

 FINAL POSITION OF EACH SPRING CLIP IS
PERPENDICULAR TO SWING BEAM.

1. NOTE: THRU HOLES LOCATIONS.
2. INSTALL SWING HANGERS TO SWING BEAM.
3. FULLY TIGHTEN ALL BOLTS AND INSTALL PLASTIC CAP AS SHOWN.

GO TO NEXT PAGE

SWING CHAIN TO HANGER

Attach a Quick-Link at the end of each swing and trapeze chain. Then, using the Quick-Links, attach the swings and trapeze to the Hanger Spring Clips on the swing beam, as shown below.

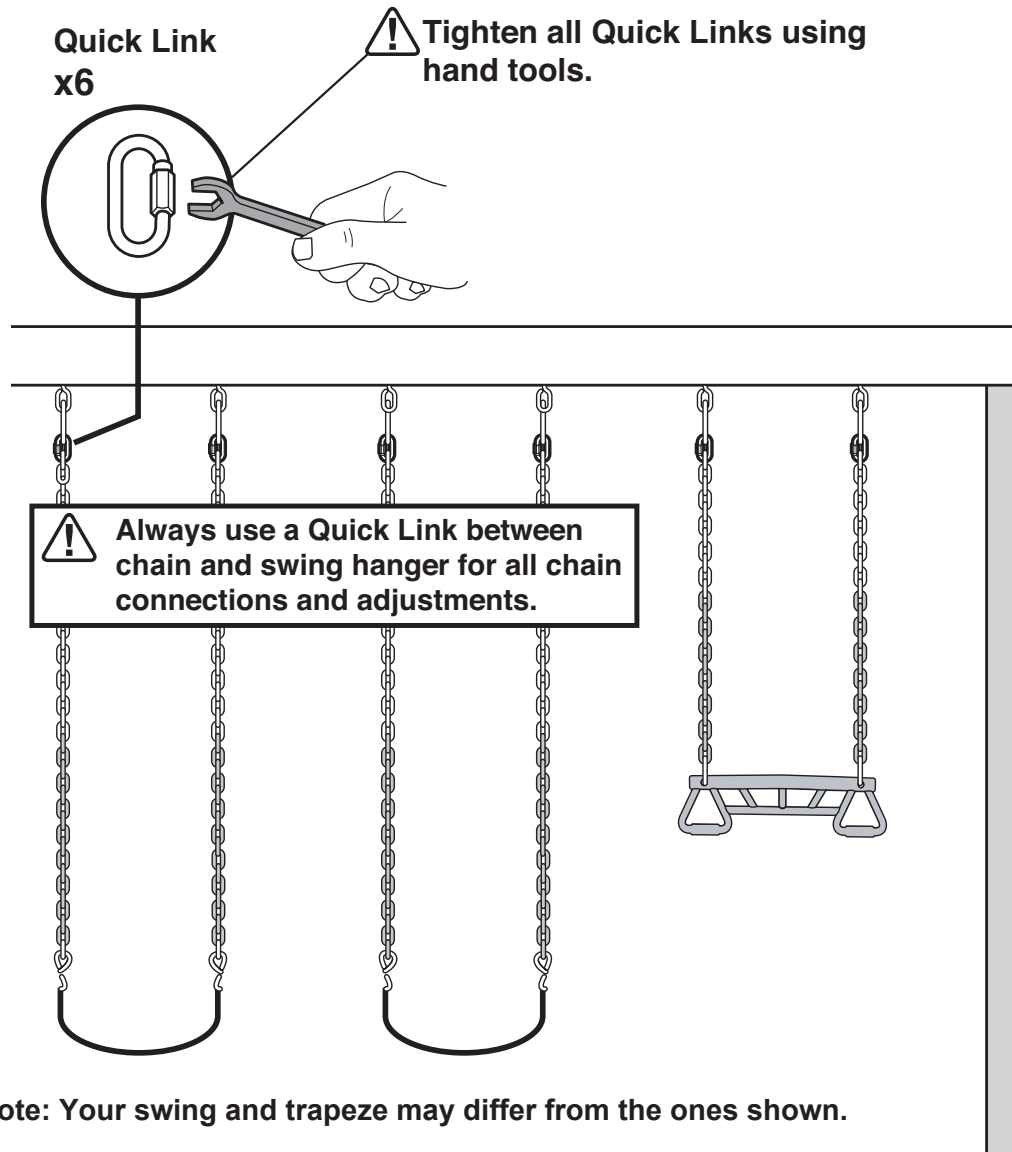

GO TO NEXT PAGE

1-1/4" Screws running change:

There are NO 1-1/4" screws included with the hardware bags to assemble the playset. Use the 1-3/16" (30mm) screws provided in the hardware bag(s) wherever a 1-1/4", 1-3/16", or 30mm screw is called out.

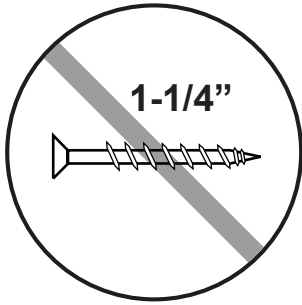

**WHEREVER YOUR INSTRUCTIONS
CALLOUT USING THE 1-1/4"
SCREW USE THE 1-3/16" SCREW**

